

Page intentionally left blank.

EXISTING AIRPORT PROPERTY - FEE SIMPLE							
REFERENCE NUMBER	TAX PARCEL NUMBER	GRANTOR	BOOK/PAGE	ACREAGE	ACQUISITION DATE	PURPOSE	
1	15E12E00000000	WARREN HOLLEBACK & GUY E. RECH ET AL.	0194000792	18.03	1977	ORIGINAL AIRPORT CONSTRUCTION	
2	15E12E00000000	WARREN HOLLEBACK & GUY E. RECH ET AL.	0194000792	1.62	1977		
3	51D13 00A00000	SEARLE & HEDERBERG COAL COMPANIES	0086000047	1.947	1947		
4	15E12E00000000	T.F. SMITH COAL COMPANY	0119100089	534.87	1963	RUNWAY 4 MAIN	
5	15E12E00000000	EDWARD WELDON & COLA HILFENST ET AL.	0102000052	1.967	3-26-53A-507		
6	15E12E00000000	EDWIN & BENE MILDON ET AL.	0103000068	1.967	3-26-53A-507		
7	15E12E00000000	PENNSYLVANIA COAL COMPANY	0108000171	1.969	3-26-53A-507	RUNWAY 4 EXTENSION	
8	15E12E00000000	ROSLYN INVESTMENT GROUP	0214000010	37.26	1985		3-42-0105-12
9	15E12E00000000	LESLIE & SALLY BROWN	0212400074	1.72	1984		
10	15E12E00000000	LESLIE BROWN JR.	0212400074	0.16	1984		
11	15E12E00000000	LESLIE BROWN JR.	0212400074	0.36	1984		
12	15E12E00000000	FRANK & CLAYTON LEY	0218100074	0.26	1982		
13	15E12E00000000	LESLIE BROWN JR.	0212400074	0.17	1984		
14	15E12E00000000	LESLIE & HARRIET BROWN	0207700046	1.31	1982		
15	15E12E00000000	JOHN & MARY ANN BARRY	0207300056	0.19	1982		
16	15E12E00000000	LESLIE BROWN JR.	0212400074	1.07	1984		
17	15E12E00000000	LESLIE BROWN JR.	0212400074	1.89	1984		
18	15E12E00000000	CECASH ASSOCIATES	0210300012	0.24	1985		
19	15E12E00000000	EDNA COLLINS	0215000027	1.08	1985		
20	15E12E00000000	BARRY & MARIE LEY	0215300087	0.14	1985		
21	15E12E00000000	BARRY & MARIE LEY	0215300087	0.14	1985		
22	15E12E00000000	RUSSELL & LEONARD LEY	0198900100	0.10	1979		
23	15E12E00000000	STANLEY & SHIRLEY LACOME	0219500030	1.11	1985		
24	15E12E00000000	HELEN MILLER	0207700059	1.09	1982		
25	15E12E00000000	HANNAH FRIEDMAN	0205800063	0.63	1981		
26	51E13 00A01000	HENRY J. BURKE	0205800078	0.20	1981		
27	51E13 00A01000	DANIEL BENEDETTO	0205800087	0.07	1981		
28	51E13 00A01000	JAMES BEVERINO BELMONT	0207200017	0.06	1982		
29	51E13 00A01000	LAWRENCE MARSA	0219400179	6.31	1988		
30	15E12E00000000	MARGARET MELEWIK	0205800084	0.31	1981		
31	15E12E00000000	MARGARET MELEWIK	0205800083	0.06	1981		
32	15E12E00000000	BEVERLY & GEORGE BUTCHER	0205200079	0.46	1981		
33	15E12E00000000	JOHN & MARY MELEWIK	0205200074	0.37	1981		
34	15E12E00000000	CHARLES MORRIS	0205800088	0.33	1981		
35	15E12E00000000	JOHN & CAROL STORNABLE	0205800084	1.48	1981		
36	15E12E00000000	EDWARD & HELEN SLEZAK	0207200013	0.47	1982		
37	15E12E00000000	BERTHA GULLORIN	0205800089	0.75	1981		
38	15E12E00000000	ELIZABETH & GERALD PERRINS	0208600025	0.64	1982		
39	15E12E00000000	BERTHA GULLORIN	0205800089	0.44	1981		
40	15E12E00000000	HELEN FRANCIS	0205800083	0.37	1981		
41	15E12E00000000	DOUGLAS C. JUMPER	0205800082	0.43	1981		
42	5D012 00A01000	MARY ROBERT REALTY CO. INC.	0198800180	1.48	2001		
43	51D13 00A01000	MICHAEL & VERNA HADDOCK	0216600155	18.29			
44	1800000000	MOORE BOROUGH		98.89			

EXISTING AIRPORT PROPERTY - AVIGATION EASEMENT						
REFERENCE NUMBER	TAX PARCEL NUMBER	GRANTOR	BOOK/PAGE	ACREAGE	ACQUISITION DATE	PURPOSE
28-1	51D13 00A00100	PARAMOUNT LAND GROUP LP	177815 MB 30PL41	17.00		RUNWAY 28 RPZ



NOTES:
 • LAND USE, PARCEL, AND ZONING DATA PROVIDED BY LACKAWANNA AND LUZERNE COUNTY GIS DEPARTMENTS.
 • AIRPORT PROPERTY BOUNDARY SURVEY BY PENNEASTERN ARCHITECTS, LLC, 2018.
 • ALL POSITIONAL DATA REFERENCES NORTH AMERICAN DATUM OF 1983 (NAD83) AND NORTH AMERICAN VERTICAL DATUM 1988 (NGVD88).
 • AERIAL MAPPING BY WOOLPERT, 2016.

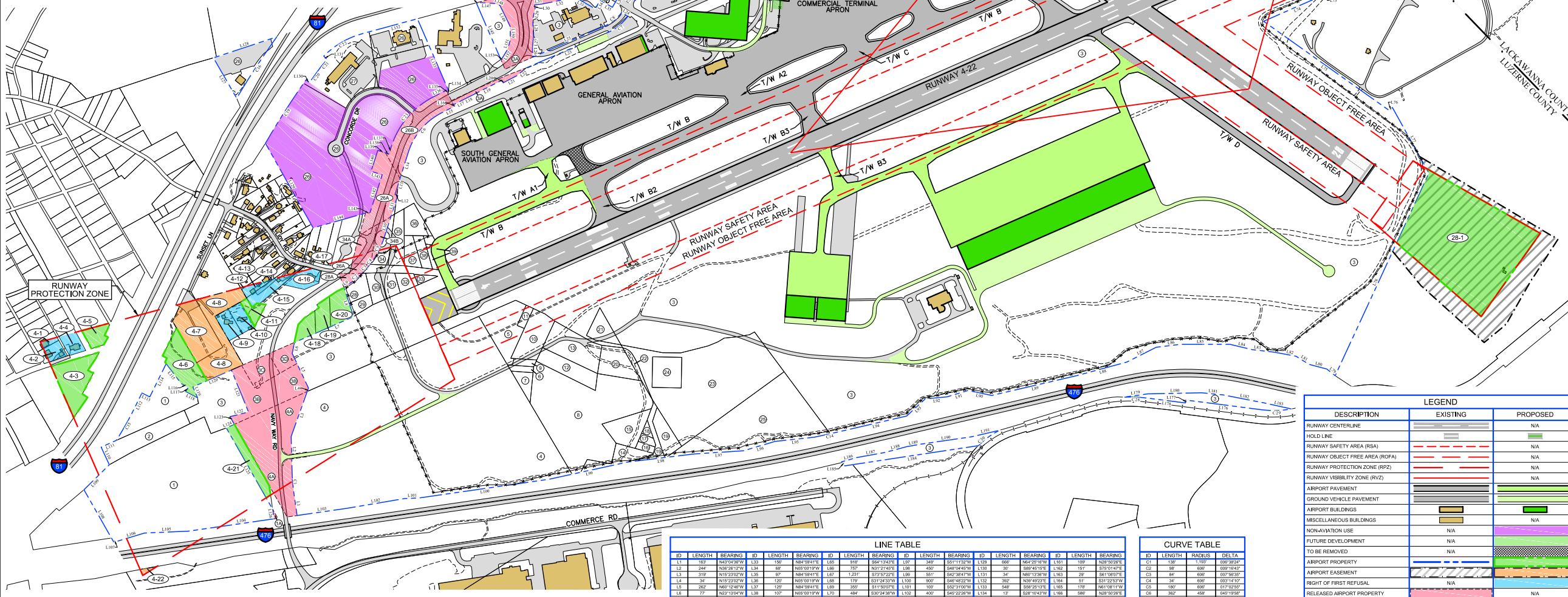

LAND RELEASE TABLE						
REFERENCE NUMBER	TAX PARCEL NUMBER	GRANTOR	GRANTEE	ACREAGE	RECORD DOCUMENT	DATE OF CONVEYANCE
1A	15E12 00A00000			0.22	198792	
3A				3.03	962471	
3B				2.47	18661171	
3C				0.26	108452	
3D				0.44	108456	
3E	51D13 00A00000			0.07	1191569	
3F		LUZERNE AND LACKAWANNA COUNTIES	STATE OF PENNSYLVANIA	0.22	1191569	
4A	15E12 00A00000			4.28	2148910	
25A				1.89	1102028	
25B	15E12 00A00000			1.62	1131028	
25C	15E12E00000000			0.17	2058003	
24A				0.44	2027213	
24B	15E12E00000000			0.28	2052954	

LINE TABLE											
ID	LENGTH	BEARING	ID	LENGTH	BEARING	ID	LENGTH	BEARING	ID	LENGTH	BEARING
L1	180	N42°30'00"W	L2	150	N88°00'00"E	L3	150	N88°00'00"E	L4	150	N88°00'00"E
L5	150	N88°00'00"E	L6	150	N88°00'00"E	L7	150	N88°00'00"E	L8	150	N88°00'00"E
L9	150	N88°00'00"E	L10	150	N88°00'00"E	L11	150	N88°00'00"E	L12	150	N88°00'00"E
L13	150	N88°00'00"E	L14	150	N88°00'00"E	L15	150	N88°00'00"E	L16	150	N88°00'00"E
L17	150	N88°00'00"E	L18	150	N88°00'00"E	L19	150	N88°00'00"E	L20	150	N88°00'00"E
L21	150	N88°00'00"E	L22	150	N88°00'00"E	L23	150	N88°00'00"E	L24	150	N88°00'00"E
L25	150	N88°00'00"E	L26	150	N88°00'00"E	L27	150	N88°00'00"E	L28	150	N88°00'00"E
L29	150	N88°00'00"E	L30	150	N88°00'00"E	L31	150	N88°00'00"E	L32	150	N88°00'00"E
L33	150	N88°00'00"E	L34	150	N88°00'00"E	L35	150	N88°00'00"E	L36	150	N88°00'00"E
L37	150	N88°00'00"E	L38	150	N88°00'00"E	L39	150	N88°00'00"E	L40	150	N88°00'00"E
L41	150	N88°00'00"E	L42	150	N88°00'00"E	L43	150	N88°00'00"E	L44	150	N88°00'00"E
L45	150	N88°00'00"E	L46	150	N88°00'00"E	L47	150	N88°00'00"E	L48	150	N88°00'00"E
L49	150	N88°00'00"E	L50	150	N88°00'00"E	L51	150	N88°00'00"E	L52	150	N88°00'00"E
L53	150	N88°00'00"E	L54	150	N88°00'00"E	L55	150	N88°00'00"E	L56	150	N88°00'00"E
L57	150	N88°00'00"E	L58	150	N88°00'00"E	L59	150	N88°00'00"E	L60	150	N88°00'00"E
L61	150	N88°00'00"E	L62	150	N88°00'00"E	L63	150	N88°00'00"E	L64	150	N88°00'00"E
L65	150	N88°00'00"E	L66	150	N88°00'00"E	L67	150	N88°00'00"E	L68	150	N88°00'00"E
L69	150	N88°00'00"E	L70	150	N88°00'00"E	L71	150	N88°00'00"E	L72	150	N88°00'00"E
L73	150	N88°00'00"E	L74	150	N88°00'00"E	L75	150	N88°00'00"E	L76	150	N88°00'00"E
L77	150	N88°00'00"E	L78	150	N88°00'00"E	L79	150	N88°00'00"E	L80	150	N88°00'00"E
L81	150	N88°00'00"E	L82	150	N88°00'00"E	L83	150	N88°00'00"E	L84	150	N88°00'00"E
L85	150	N88°00'00"E	L86	150	N88°00'00"E	L87	150	N88°00'00"E	L88	150	N88°00'00"E
L89	150	N88°00'00"E	L90	150	N88°00'00"E	L91	150	N88°00'00"E	L92	150	N88°00'00"E
L93	150	N88°00'00"E	L94	150	N88°00'00"E	L95	150	N88°00'00"E	L96	150	N88°00'00"E
L97	150	N88°00'00"E	L98	150	N88°00'00"E	L99	150	N88°00'00"E	L100	150	N88°00'00"E

CURVE TABLE			
ID	LENGTH	RADIUS	DELTA
C1	150	1500	90.000000
C2	150	1500	90.000000
C3	150	1500	90.000000
C4	150	1500	90.000000
C5	150	1500	90.000000
C6	150	1500	90.000000
C7	150	1500	90.000000
C8	150	1500	90.000000
C9	150	1500	90.000000
C10	150	1500	90.000000
C11	150	1500	90.000000
C12	150	1500	90.000000
C13	150	1500	90.000000
C14	150	1500	90.000000
C15	150	1500	90.000000
C16	150	1500	90.000000
C17	150	1500	90.000000
C18	150	1500	90.000000
C19	150	1500	90.000000
C20	150	1500	90.000000
C21	150	1500	90.000000
C22	150	1500	90.000000
C23	150	1500	90.000000
C24	150	1500	90.000000
C25	150	1500	90.000000
C26	150	1500	90.000000
C27	150	1500	90.000000
C28	150	1500	90.000000
C29	150	1500	90.000000
C30	150	1500	90.000000

LEGEND		
DESCRIPTION	EXISTING	PROPOSED
RUNWAY CENTERLINE	---	N/A
HOLD LINE	---	---
RUNWAY SAFETY AREA (RSA)	---	---
RUNWAY OBJECT FREE AREA (ROFA)	---	---
RUNWAY PROTECTION ZONE (RPZ)	---	---
RUNWAY VISIBILITY ZONE (RVZ)	---	---
AIRPORT PAVEMENT	---	---
GROUND VEHICLE PAVEMENT	---	---
AIRPORT BUILDINGS	---	---
MISCELLANEOUS BUILDINGS	---	---
NON-AVIATION USE	---	---
FUTURE DEVELOPMENT	---	---
TO BE REMOVED	---	---
AIRPORT PROPERTY	---	---
AIRPORT EASEMENT	---	---
RIGHT OF FIRST REFUSAL	---	---
RELEASED AIRPORT PROPERTY	---	---

PROPOSED AIRPORT PROPERTY - FEE				
REFERENCE NUMBER	TAX PARCEL NUMBER	GRANTOR	ACREAGE	PURPOSE
4-3	15E12E00000000	SACRED HEART CHURCH	1.06	
4-5	15E12E00000000	FRYZEL ANN VERA JEROME	0.44	
4-6	15E12E00000000	LOWER LACKAWANNA SANITARY AUTHORITY	1.43	
4-11	15E12E00000000	COMMONWEALTH OF PA	0.33	RPZ CONTROL
4-18	15E12E00000000	COMMONWEALTH OF PA DEPT OF TRANS	0.41	
4-19	15E12E00000000	COMMONWEALTH OF PENNA DEPARTMENT OF	0.45	
4-20	15E12E00000000	COMMONWEALTH OF PA DEPT OF TRANS	0.46	
4-21	15E12E00000000	LOWER LACKAWANNA		